

# MEETING AMENITIES

## FLOOR PLAN

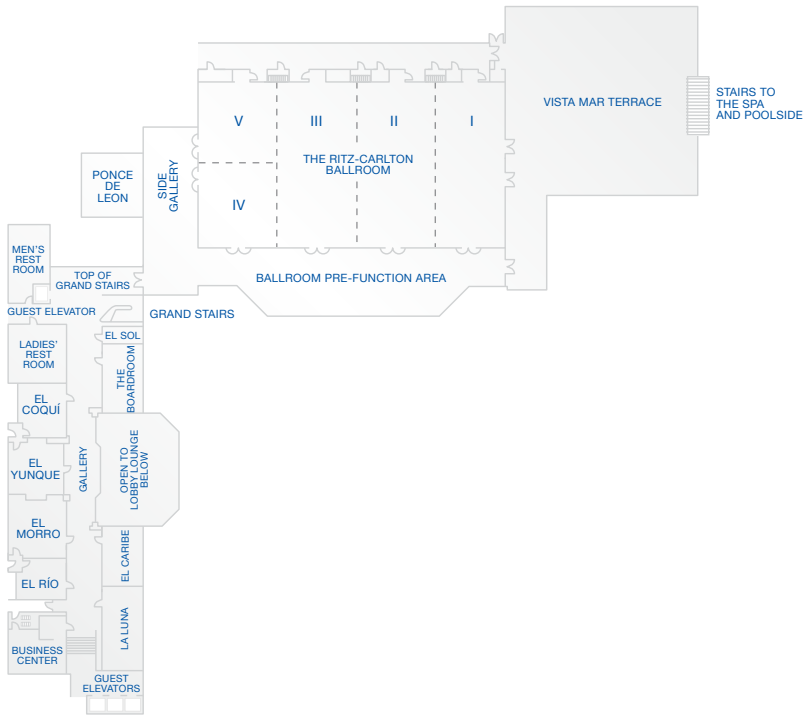

## OVERVIEW

- More than 2,550 square meters/27,457 square feet of meeting and event space
- 1,100 square-meter/11,840 square-foot, four-section ballroom
- 345.4 square meters/3,718 square feet of pre-function space
- 635-square-meter/6,840-square-foot function terrace, beach area and wedding gazebo
- Nine meeting rooms, including the boardroom, with a total of 469 square meters/5,059 square feet of indoor space
- Technology Butler® services
- Wireless, high-speed Internet access
- Conference Concierge
- Banquet and catering services staff
- State-of-the-art audio-visual equipment and technicians
- Business Center located on the meeting rooms level
- On-site professional meeting and special events managers
- Destination Services available
- Fully-equipped, private



**THE RITZ-CARLTON**

SAN JUAN

6961 AVE GOBERNADORES, CAROLINA, PUERTO RICO 00979

PH +1.787.253.1700 RITZCARLTON.COM/SANJUAN

# ROOM SIZES AND CAPACITY

	Square feet	Square meters	Dimensions in feet	Dimensions in meters	Ceiling Height (ft)	Ceiling Height (m)	Rounds of 10	Theater	Reception	Conference	Classroom	Ushaped	Hollow Square
<b>The Ritz-Carlton Ballroom</b>	11,840	1,100.5	148x80	45.1x24.3	15	4.5	1,200	760	1,200	-	720	-	-
<b>Ballroom Pre-function Area</b>	3,718	345.4	143x26	43.5x7.9	-	-	-	400	-	-	-	-	-
<b>Salon I</b>	2,960	274.9	37x80	11.3x24.3	15	4.5	180	190	225	65	180	63	65
<b>Salon I &amp; II</b>	5,920	549.9	74x80	22.6x24.3	15	4.5	380	450	130	360	126	130	
<b>Salon I, II &amp; III</b>	8,880	824.9	111x80	33.8x24.3	15	4.5	540	570	675	195	540	189	195
<b>Salon IV or V</b>	1,480	137.5	37x40	11.3x12.2	15	4.5	200	160	256	68	144	66	72
<b>Ponce de Leon</b>	522	48.5	29x18	8.8x5.4	11	3.3	30	30	43	12	27	21	20
<b>El Coquil</b>	572	53.1	22x26	6.7x7.9	11	3.3	40	44	15	27	15	24	
<b>El Yunque</b>	575	53.4	23x25	7x7.6	11	3.3	45	30	42	20	36	21	24
<b>El Morro</b>	756	70.2	27x28	8.2x8.5	11	3.3	50	60	20	36	27	30	
<b>El Rio</b>	420	39	20x21	6x6.4	11	3.3	30	30	32	12	24	15	18
<b>El Caribe</b>	570	52.9	19x30	5.8x9.1	11	3.3	40	36	22	24	20	24	
<b>La Luna</b>	780	72.4	19x40	5.8x12.1	11	3.3	50	60	28	39	28	32	
<b>The Boardroom</b>	600	55.7	20x30	6x9.1	8	2.4	-	-	-	12*	-	-	-
<b>El Sol</b>	264	24.5	11x24	3.3x7.3	8	2.4	-	-	-	8*	-	-	-

\*The Boardroom has existing board table with 12 chairs/El Sol has existing board table with eight chairs.  
(Staging and special set-up requirements will determine exact space capacity)